

(2+1)x1 Multimode Fiber Pump Combiner

Features	
High Coupling Efficiency & Low Insertion Loss High Power High stability and reliability	
Application	
Fiber Laser High Power Amplifier	

Specification

Working WL (nm)	Input pump	Input signal	Output fiber	Signal IL Spec	Pump Effi. spec	Package
1060	105/125 0.22	HI1060	6/125 0.14/0.46	0.5dB	90%	3x54mm 70x12x8mm
1060	105/125 0.22	HI1060	20/125 0.08/0.46	0.5dB	90%	
1060	105/125 0.22	6/125 0.14/0.46	6/125 0.14/0.46	0.5dB	90%	
1550	105/125 0.22	SMF-28	8/125 0.14/0.46	0.5dB	90%	
1550	105/125 0.22	8/125 0.14/0.46	8/125 0.14/0.46	0.5dB	90%	
1060	105/125 0.22	HI1060	10/125 DCF	0.5dB	90%	
1060	105/125 0.22	10/125 DCF	10/125 DCF	0.5dB	90%	
1060	105/125 0.22	20/125 DCF	20/125 DCF	0.5dB	90%	

Package Dimensions

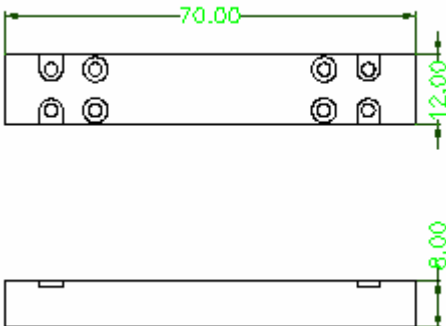

Ordering Information

MPC	Port Type	Pump fiber	Signal fiber	Output fiber	Length	Package
	(2+1)x1	105/125 0.22	HI1060 6/125 DC 20/125 DC 10/125 DC 20/125 DC 25/250 DC	6/125 DC 20/125 DC 10/125 DC 20/125 DC 25/250 DC	0.8=0.8m 1=1m	3x54 70x12x8

(2+1)x1 Multimode Fiber Pump Combiner

Type	Signal Working	Pump Working	Input pump	Input signal	Output Signal	Signal IL(dB)	Pump Effi.(%)	Per Pump Power(W)	ER (dB)
(2+1)x1	1500-1600	800-1000	105/125 0.22	SM-GDF-5/130(0.12/0.46)	6/125 DC(0.12/0.46)	<0.5	>90%	25	
(2+1)x1	1500-1600	800-1000	105/125 0.22	11/125 DC or SMF-28e (NA0.14)	11/125DC NA 0.12/0.46	<0.5	>90%	25	
(2+1)x1	1000-1100	800-1000	105/125 0.22	SM-GDF-5/130(NA0.12/0.46) or HI1060 (NA 0.14)	SM-GDF-5/130(NA0.12/0.46)	<0.5	>90%	25	
(2+1)x1	1000-1100	800-1000	105/125 0.22	LMA-GDF-10/130-M(0.08/0.46)	LMA-GDF-10/130-M(0.08/0.46)	<0.5	>90%	25	
(2+1)x1	1000-1100	800-1000	105/125 0.22	LMA-GDF-20/130(NA 0.08/0.46)	LMA-GDF-20/130(NA 0.08/0.46)	<0.5	>90%	25	
(2+1)x1	1000-1100	800-1000	105/125 0.22	LMA-GDF-25/250-M(NA 0.065/0.46)	LMA-GDF-25/250-M(NA 0.065/0.46)	<0.5	>90%	25	
(2+1)x1	1000-1100	800-1000	200/220 0.22	LMA-GDF-20/400-M(NA 0.065/0.46)	LMA-GDF-20/400-M(NA 0.065/0.46)	<0.5	>90%	25	
PM (2+1)x1	1500-1600	800-1000	105/125 0.22	PM1550/ PM-GDF 1550 DCF (NA 0.12/0.46)	PM-GDF 1550 DCF (NA 0.12/0.46)	0.5dB	90%	>25	>18dB
PM (2+1)x1	1500-1600	800-1000	105/125 0.22	PM1550/ PM-GDF 12/130 DCF (NA 0.20/0.46)	PM-GDF -12/130 DCF (NA 0.20/0.46)	0.5dB	90%	>25	>18dB
PM (2+1)x1	1000-1100	800-1000	105/125 0.22	PM-GDF-5/130 (NA 0.12/0.46) or PM980	PM-GDF-5/130 (NA 0.12/0.46)	0.5dB	90%	>25	>18dB
PM (2+1)x1	1000-1100	800-1000	105/125 0.22	PLMA-GDF-10/125-M(NA 0.08/0.46)	PLMA-GDF-10/125-M(NA 0.08/0.46)	0.5dB	90%	>25	>18dB
PM (2+1)x1	1000-1100	800-1000	105/125 0.22	PLMA-GDF-20/130 (NA 0.08/0.46)	PLMA-GDF-20/130 (NA 0.08/0.46)	0.5dB	90%	>25	>18dB
PM (2+1)x1	1000-1100	800-1000	105/125 0.22	PLMA-GDF-25/250-M (NA 0.06/0.46)	PLMA-GDF-25/250-M (NA 0.06/0.46)	0.5dB	90%	>25	>18dB
PM (2+1)x1	1000-1100	800-1000	105/125 0.22	PLMA-GDF-30/250-M (NA 0.06/0.46)	PLMA-GDF-30/250-M (NA 0.06/0.46)	0.5dB	90%	>25	>18dB

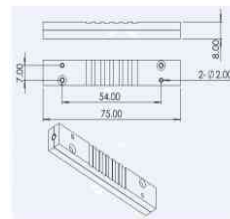
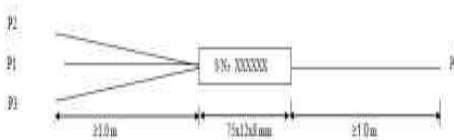

Order Information :

MPC/PMMP	Working WL (nm)	Port	Pump Fiber	Signal Input	Output fiber	Length	Package
MPC=MPC	1550=1550	211=(2+1) x 1	22=105/125 NA0.22	06DC=6/125DC	08DC=8/125DC	1=1m	1=0D4x65mm
PMMP=MMP	1064=1064			10DC=10/125 DC	10DC=10/125 DC	X=other	2=AL75x12x8
				11DC=11/125DC	11DC=11/125DC		
				25DC=25/250DC	25DC=25/250DC		
				20DC=20/125DC	20DC=20/125DC		

				XXDC=XX fiber	XXDC=XX fiber MFD		
--	--	--	--	---------------	-------------------	--	--

XXSC=XX=fiber MXXSC=XX=fiber MFD